

Mackenzie House, Chadwick Street, Hunslet, Leeds, LS10

Approximate Area = 428 sq ft / 40 sq m

For identification only - Not to scale

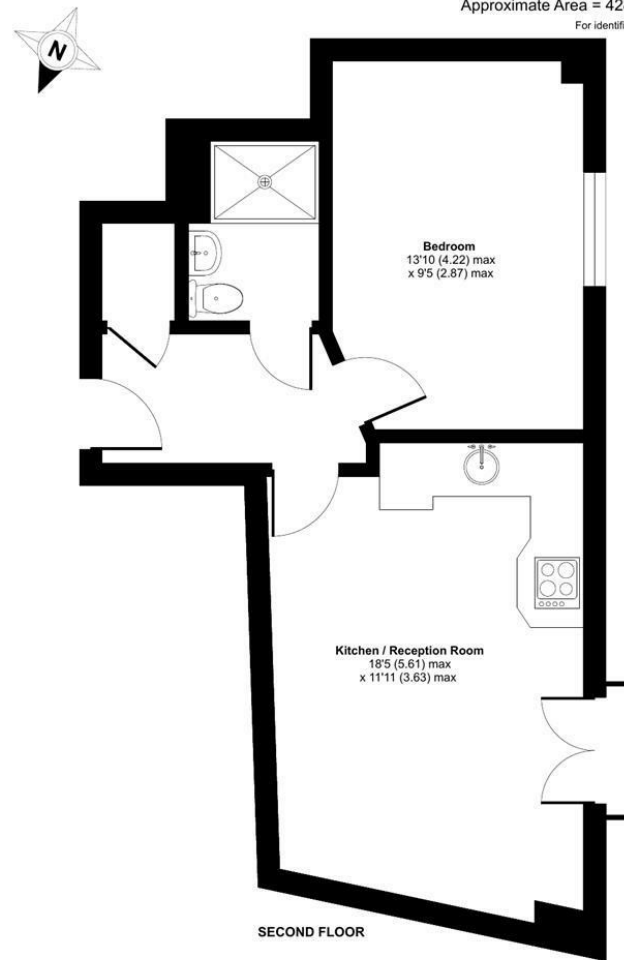

Certified Property Measurer Floor plan produced in accordance with RICS Property Measurement Standards incorporating International Property Measurement Standards (IPMS2 Residential). © nichcom 2022. Produced for Vision Properties. REF: 904573.

Chadwick Street, LS10



PROPERTY ADDRESS
121 Mackenzie House
Chadwick Street
Hunslet
Leeds
Yorkshire
LS10 1PU

Energy Efficiency Rating		Current	Potential
Very energy efficient - lower running costs			
(92 plus) A			
(81-91) B			
(69-80) C			
(55-68) D		71	78
(39-54) E			
(21-38) F			
(1-20) G			
Not energy efficient - higher running costs			
England & Wales	EU Directive 2002/91/EC		



Call Us
01132440251

Email Us
leeds@vision-properties.co.uk

vision

We look at
estate agency
differently.

vision

- Total cost of first month: £1,798.46 (rent & deposit)
- Spacious apartment
- Available now
- Unfurnished
- Leeds Dock

Vision Properties are delighted to offer this unfurnished one bedroom apartment at the popular Leeds Dock.

This spacious apartment briefly comprises of an open plan living, dining and kitchen, a double bedroom and bathroom with shower enclosure.

It's in a great location in Leeds Dock, with an abundance of local shops and amenities on your doorstep including the water taxi, Royal Armouries museum and Brewery Wharf, all within a short walk of the city centre.

Available immediately pending acceptable referencing.

Rent: £835 per calendar month
 Holding deposit: £192.69
 Deposit: £963.46



1 bedroom
 Apartment
 £835 PCM



This spacious apartment briefly comprises of an open plan living, dining and kitchen, a double bedroom and bathroom with shower enclosure.

It's in a great location in Leeds Dock, with an abundance of local shops and amenities on your doorstep including the water taxi, Royal Armouries museum and Brewery Wharf, all within a short walk of the city centre.

Available immediately pending acceptable referencing.

Rent: £835 per calendar month
 Holding deposit: £192.69
 Deposit: £963.46